

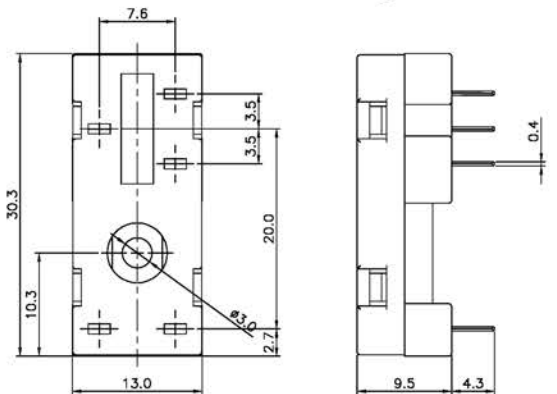

UL/CUL No: E306487

Dimensions



Accessories

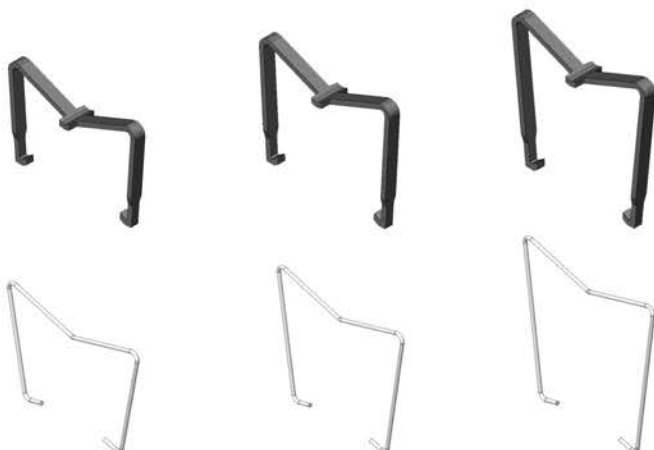

Main Feature

- Socket with PCB terminal.
- No reduction of protection class or creepage/clearance with plastic retainer.
- Easy replacement of relays.
- Socket can be used as connector for diagnosis function.
- Sockets and accessories: RoHS compliance (Directive 2002/95/EC).
- Socket with PCB-type terminal.

Specifications

Rated current.....12A
 Rated voltage / max. Switching voltage AC..150/300VAC
 Dielectric strength coil-contact circuit.....2,500V_{rms}
 Clearance / creepage coil-contact circuit..... $\geq 4/4$ mm
 Material group of insulation parts..... \geq IIIa
Insulation to IEC 60664-1
 Type of insulation coil-contact circuit.....reinforced
 Open contact circuit.....functional
 Rated insulation voltage.....250V
 Pollution degree.....2
 Rated voltage system.....230/400V
 Over voltage category..... III
RoHS Directive 2002/95/EC
 Sockets, retainers and marking tag:.....compliant
 Degree of protection DIN 40050.....IP20
 Ambient temperature range.....-25... +70°C
 Terminals.....PCB
 Insertion cycles.....A (10)
 Max. Insertion Force total.....100N
 Mounting distance.....0, dense packing
 Weight.....3g
 Packaging unit.....100 pcs.

Order Information

CSR - P 35

Terminal pitch	35 (for 3.5mm terminal pitch) 50 (for 5.0mm terminal pitch)
Contact form	P (for PCB terminal)
Item	CSR